

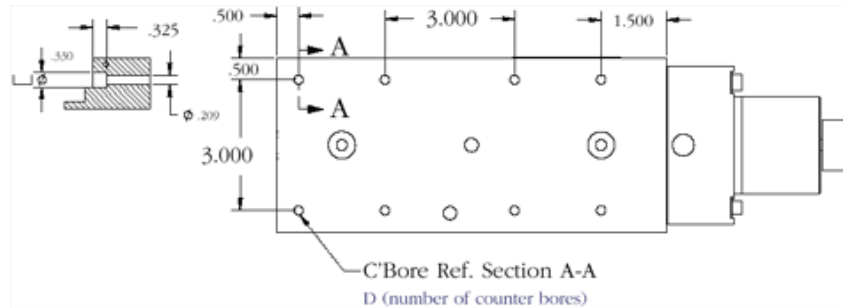

## LMB-600™ Stage

### Dimensions - Bottom View



### Dimensions - End View

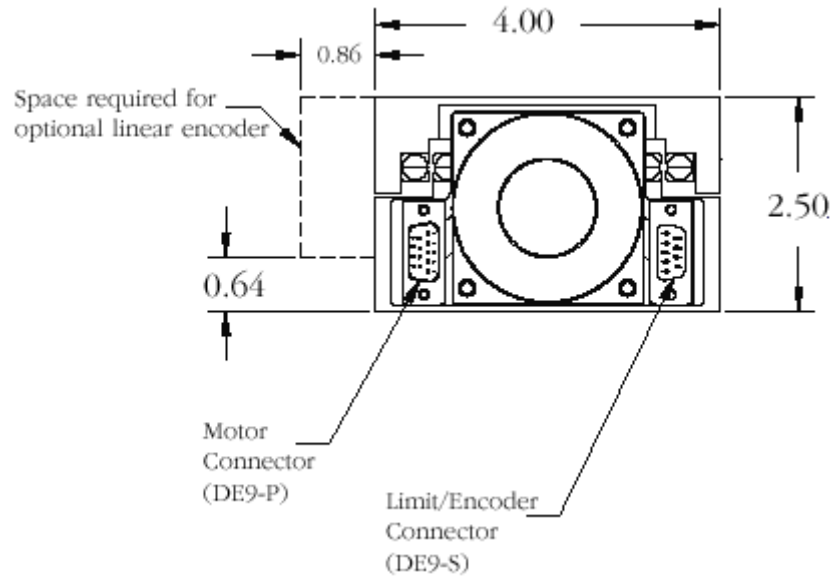

## LMB-600™ Stage

### Specifications

Travel (inches)		6
Positional Accuracy (μm)	w/linear encoders open loop	15 20
Bi-directional Repeatability (μm)	w/linear encoder open loop	±1 count 1 μm
Flatness & Straightness (μm)		8
Pitch & Yaw (arc-seconds)		25
Load Capacity (kg) <sup>1</sup>		125
Mass (kg)	Moving Total	0.9 3.9

### Configurations

BallScrew	Lead (mm)	2, 5
Motor	Stepper (oz-in)	400 step/rev 200 step/rev
	Servo <sup>3</sup>	brush, brushless

### Options

Encoder	Rotary (counts/rev.)	2000, 4000
	Linear (μm/count) <sup>3</sup>	5, 1, 0.5, 0.1

NEMA 23 in-line brake available for vertical applications.

<sup>1</sup> Please contact our Applications Engineers for loads exceeding 35kg.