

# LMB-1000™ Stage

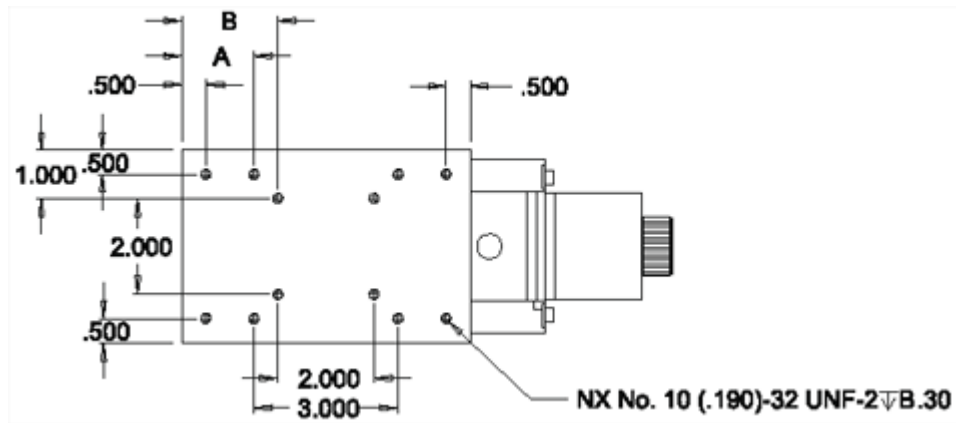

## Product Dimensions

### Dimensions - Top View



### Dimensions - Side View

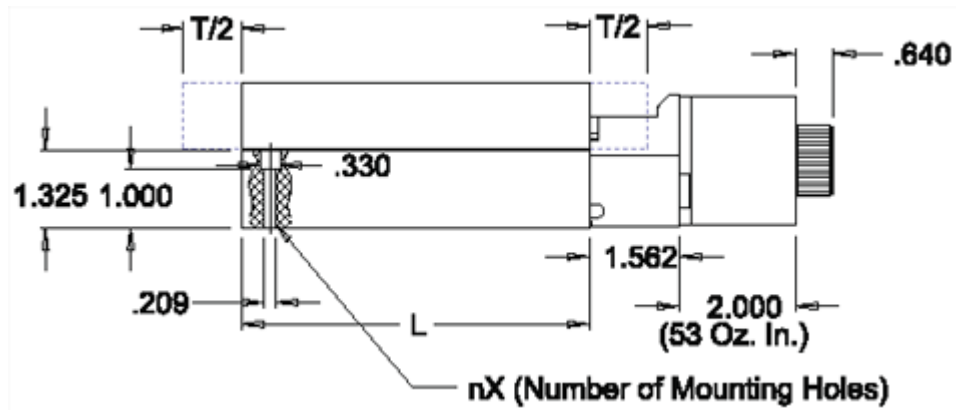

**LMB-1000™ Stage**

**Dimensions - Bottom View**

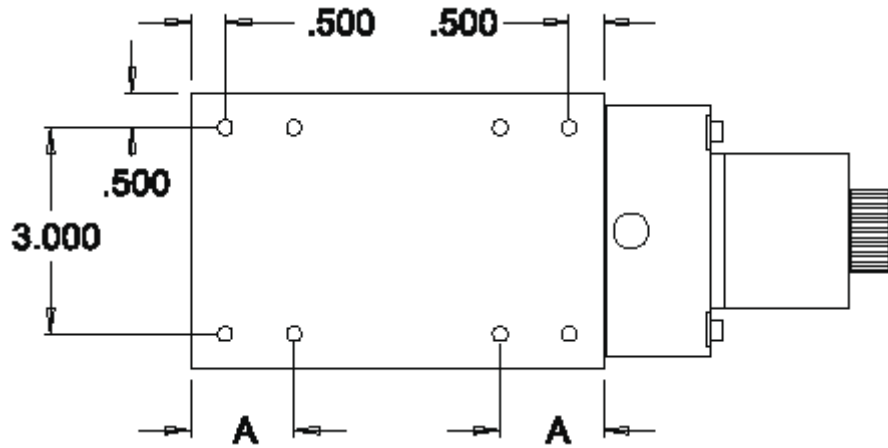

**Dimensions - End View**

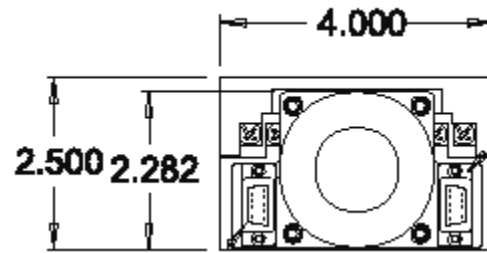

## LMB-1000™ Stage

### Specifications

Travel (inches)		10
Positional Accuracy (µm)	w/linear encoders open loop	25 30
Bi-directional Repeatability (µm)	w/linear encoder open loop	±1 count 1 µm
Flatness & Straightness (µm)		12
Pitch & Yaw (arc-seconds)		35
Load Capacity (kg) <sup>1</sup>		175
Mass (kg)	Moving Total	1.4 5.2

### Configurations

BallScrew	Lead (mm)	2, 5
Motor	Stepper (oz-in)	400 step/rev 200 step/rev
	Servo <sup>3</sup>	brush, brushless

### Options

Encoder	Rotary (counts/rev.)	2000, 4000
	Linear (µm/count) <sup>3</sup>	5, 1, 0.5, 0.1

NEMA 23 in-line brake available for vertical applications.

<sup>1</sup> Please contact our Applications Engineers for loads exceeding 35kg.